



# Women in the recovery



**Sheree Holland**

**Occupation: Brickies labourer, T Q Brick & Block**

Sheree Holland has been working as a brickie for about the past year. She was looking for a career change from farm work, likes working in the outdoors and doesn't mind working hard. Sheree says there was a bit of training but it's mostly common sense.

**What does working in the recovery mean to her?**

"We do a lot of fences and walls and people are just really stoked to have their fence back up. Owners will come round and you can see the sheer joy on their faces, after years and years of waiting."

"I encourage any woman to work in the recovery – women and young girls leaving school. There's plenty of training out there for lots of different trades. Just go for it, it's not that intimidating, I've never had a negative word."



**Tessa Flaws**

**Occupation: Engineering design coordinator, Stronger Christchurch Infrastructure Rebuild Team (SCIRT)**

Tessa's current position is assisting SCIRT's design manager with overall delivery of \$100 million (project cost estimates) of engineering concept and detailed design each month. Tessa coordinates activities between SCIRT's four design teams (176 designers) and other teams.

**What does working in the recovery mean to her?**

"There's a real purpose to your daily work – everyone has this shared goal to get the city back on its feet and we are all working in the same direction."



**Alicia Janssen**

**Occupation: Site Traffic Management Supervisor, SCIRT's Downer team**

Alicia has been working in traffic management for three or four years but followed the work from Hamilton to Christchurch about two years ago. Her job is to implement layout plans to manage traffic while roading work is underway. Alicia is currently managing a major traffic project on the Travis/Frosts Road intersection.

**What does working in the recovery mean to her?**

"It's awesome. You go to a road initially and it's completely damaged. After you've spent quite a bit of time there, they do all the kerbing and channelling and the road's nice. People come out and say 'thank you so much'."

"For women thinking about working in the recovery, I say go for it. It's 2013. There's no reason why women can't be here doing it. There's heaps of us. We back each other up."

## Building back better

As the rebuild gains momentum, demand for construction labour is increasing in greater Christchurch and is yet to peak. Canterbury's economic recovery depends on a labour supply that meets demand now and into the future. Many women are already working in the recovery, but recent research by the Ministry of Women's Affairs shows that there is a hidden pool of female labour which, if better utilised, will help build a prosperous and productive Canterbury.

The research *Building back better: Utilising women's labour in the Canterbury recovery* is based on a survey of 500 women. About half the respondents were unemployed but not receiving a benefit; the remainder were working but indicated they would be open to changing occupation.

The research found that the top three factors that would encourage women to consider any job in the rebuild were: flexible hours and environment; good pay; and more information about rebuild opportunities.

Over half the women surveyed were not opposed to rebuild positions, but many had not considered these jobs, or were not sure how to access them. Women saw construction jobs as 'jobs for men'. That kind of idea is what the Ministry of Women's Affairs is keen to see debunked.

SCIRT design engineer Jeanette White sees rebuild work as something anyone can do. She says the greater Christchurch rebuild is the biggest civil engineering project ever undertaken in New Zealand's history.

"Why would you not want to be a part of that? I've never been one to sit on the side-line and it's an exciting, once in a life time opportunity to be a part of a team that is reshaping a whole city."

Ministry Chief Executive Dr Jo Cribb says making the most of the female labour force in the construction sector may mean changing employer practice, including recruitment; providing more information about rebuild occupations; and encouraging women to train or retrain.

### For women looking to get their career started in the Canterbury rebuild:

- Christchurch Polytechnic Institute of Technology (CPIT) is offering women free tuition for all Pre Trade and Engineering programmes in 2014. To find out more about CPIT's extensive range of programmes, go to: [www.cpit.ac.nz](http://www.cpit.ac.nz) or call **0800 24 24 76**.
- Contact the Canterbury Skills and Employment Hub at [www.opportunitycanterbury.org.nz](http://www.opportunitycanterbury.org.nz)

For a copy of the full research report *Building back better: Utilising women's labour in the Canterbury recovery* as well as a summary of the research, go to: [www.mwa.govt.nz](http://www.mwa.govt.nz)

# Further Avon River Precinct plans revealed

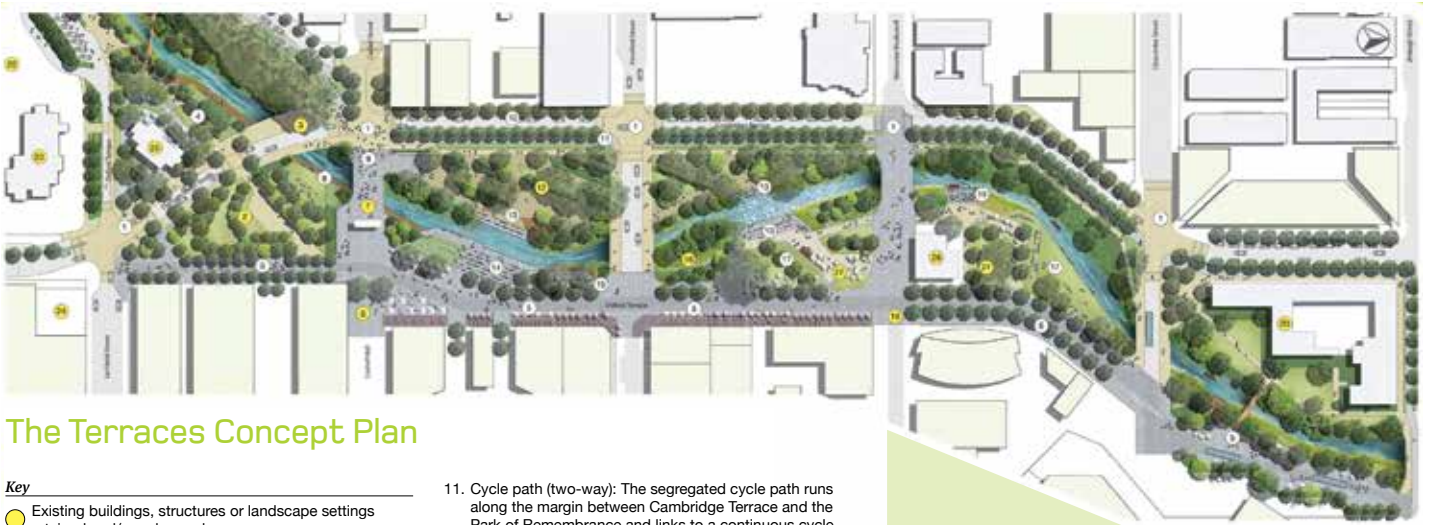

## The Terraces Concept Plan

### Key

Existing buildings, structures or landscape settings retained and/or enhanced

1. New safer pedestrian crossings for the promenade.
2. Friendship Corner: a series of grassed terraces will create an informal amphitheatre for performance and events.
3. Durham Street South Bridge: narrowed roads and widened pedestrian areas.
4. Improved pedestrian path, linking Oxford Terrace and Cashel Street to the Health Precinct via the riverbank.
5. The promenade creates a broad pedestrian area along the east bank of the river from Lichfield Street through to Victoria Square, and connecting the Justice Precinct with the Convention Centre. A single level of paving extends out from the active building frontages, creating accessible spaces, and allowing for a range of uses including outdoor dining/spill out space, markets and events.
6. Tram route to be integrated within the promenade.
7. Bridge of Remembrance and Remembrance Arch: in association with the RSA, the Bridge of Remembrance will be re-tiled and upgraded to match the new paving.
8. Riverside boardwalk.
9. New 'Grand Staircase' to the Bridge of Remembrance. In association with the RSA, the Staircase will improve east-west connections along Cashel Street and better commemorate the processional route taken by soldiers during World War I.
10. Cambridge Terrace from Cashel Street to Gloucester Street: subject to An Accessible City consultation, speed reduced to 30km/hr and narrowed to two lanes, one way.

11. Cycle path (two-way): The segregated cycle path runs along the margin between Cambridge Terrace and the Park of Remembrance and links to a continuous cycle route through the city.
12. Park of Remembrance: retained as a 'soft', informal park space and place of remembrance.
13. Smaller river-edge terraces provide access down to the water's edge and areas of informal seating.
14. The main terraces create improved and much enlarged access to the river's edge. The Terraces will be a sunny, sheltered area during the day and become seating for viewing performances, events and outdoor theatre on the Park of Remembrance at night.
15. Ramped access to the river to make this an accessible place for everyone.
16. Mill Island and its setting is retained and enhanced.
17. A series of sunny riverside lawns and grassed terraces, suitable for small temporary or permanent retail structures such as kiosks, cafes or stalls.
18. Tram to Cathedral Square.
19. New punt landing area.
20. Canterbury Provincial Chambers.
21. The Kate Sheppard Memorial is relocated within this area to respond more appropriately to the enhanced setting.
22. St Michael and All Angels School.
23. St Michael and All Angels Church.
24. Justice and Emergency Services Precinct.
25. Tiffany's Restaurant.
26. Municipal Chambers (Our City O-Tautahi).
27. Robert F. Scott Statue.

### Concept designs have been released for the next stage of Te Papa Ōtākaro/Avon River Precinct, which will be called The Terraces.

The naming of Te Papa Ōtākaro/Avon River Precinct's next section recognises the terracing that will flow down to the water and enhance the area between the Bridge of Remembrance and Victoria Square. It will include space for entertainment and public gatherings with a small stage, and possibly a big screen.

The Government has allocated around \$100 million for Te Papa Ōtākaro/Avon River Precinct, including the already-completed Watermark stage. It will cost around \$16 million to complete this second section. Above-ground work on The Terraces will get underway in February next year, following repairs starting this month to damaged underground wastewater pipes.

The release of the concept designs for The Terraces coincided with the turning of the first sod on The Terrace development of Christchurch investor Antony Gough. The project is the first private development to start construction in the city's Retail Precinct, which Minister for Canterbury Earthquake Recovery Gerry Brownlee says will kick-start a new level of economic activity in the CBD. Nine Outline Development Plans have been consented in the Retail Precinct, with further works planned to begin early next year.

For more information, go to: [www.ccd.govt.nz](http://www.ccd.govt.nz)

For an updated CCDU central city progress map, visit: <http://progressmap.ccd.govt.nz>



**Hon Gerry Brownlee**  
Minister for Canterbury Earthquake Recovery

### I've had the pleasure recently of being able to mark some real signs of progress in greater Christchurch.

In the central city, CERA's Christchurch Central Development Unit has been able to release concept plans on the next stage of Te Papa Ōtākaro/Avon River Precinct. This stage, named The Terraces, brings to life a vision of a place where the city and the river are intrinsically connected; an attractive public space for people to gather together and enjoy.

Stage two of the river precinct will also connect with commercial projects such as Antony Gough's retail and

hospitality development, The Terrace. I was lucky enough to get behind the wheel of a digger again and help turn the first sod on that development. Antony Gough has, right from the outset, been an incredibly positive voice for recovery in greater Christchurch. I want to celebrate this project, not just as a success for Antony Gough, but as a first positive step for the Retail Precinct and another milestone on the way to recovery.

In other signs of central city progress in recent weeks, the Yeo family have begun their Awly Investments office and retail development, on the old site of the Amuri Courts on Durham Street. And the Heritage Hotel has also reopened in Cathedral Square.

We have also seen progress in terms of housing in greater Christchurch. An open day was recently held at the new Rangers Park temporary village in Linwood. Some units at Rangers Park are already in use for displaced households and the village will be fully functional by December. That

will provide another 40 temporary houses, bringing the total number to 124; including the three villages (Kaiapoi, Linwood and Rawhiti) already in use.

Housing New Zealand (HNZ) has also opened several newly built homes in St Martins. They are the first of 700 new houses that HNZ has committed to building by the end of 2015.

As I have said before, the redevelopment of both the city and the residential sector are equally important. We cannot have a city without residents, nor can we have a vibrant populace without a functioning city.

We are on track for success in both, and I look forward to marking further milestones and progress achievements as we reach them. 🇳🇿

*Gerry Brownlee*



BNZ Amazing Place exhibition container: school students make use of the interactive technology to explore the vision for the rebuilt central city.

## CHILDREN'S VISIONS FOR A FUTURE CHRISTCHURCH ON DISPLAY

**Two exhibitions of entries by Canterbury children in the BNZ Amazing Place competitions are now open to the public.**

Earlier this year, children from early-childhood to high school age in Canterbury were invited to take part in a series of competitions run by the Christchurch Central Development Unit (CCDU). In each one, they were encouraged to present their ideas and visions for the rebuilt central city.

The first display, in CCDU's multimedia exhibition container next to the 'green lounge suite' on Gloucester Street, opened late last month. Held in cooperation with SCAPE 7 Public Art Christchurch Biennial, it will run until 9 November 2013.

The second exhibition is at Canterbury Museum. This features a selection of entries from the BNZ Amazing Place Project Competition. Students from years 7 to 13 were challenged to come up with design ideas for a project within the new CBD. The exhibition, which opened on 27 September, continues until 29 October 2013.

The prize winners of the project competition will be announced at a special awards ceremony on 29 October. The Governor-General will present the prizes for winners at each year level.

CCDU Director Warwick Isaacs says giving young people an effective voice in the building of the city is very important, so they feel part of its creation. After all, he says, they are the future of the city.

## Government workers to support the greater Christchurch recovery

**The revitalisation of the Christchurch central city has been given a boost by the promise of an influx of government workers.**

On a visit to the region last month, Prime Minister John Key announced that around 1,700 government employees from 20 departments and agencies will be brought back into the city during 2016.

The government agencies are expected to move into four new buildings around the Retail Precinct. The departmental offices will occupy about 24,000 square metres of space in buildings built to at least 100 per cent of the Building Code.

The Government has been advised the move will mean a total additional cost of about \$90 million over 20 years, or an average of \$5.6 million a year from 2016/17. ♻️

## PGC site purchased by the Crown

**The site where the Pyne Gould Corporation (PGC) building once stood has been purchased by CERA's Christchurch Central Development Unit (CCDU) on behalf of the Crown.**

In the February 2011 earthquake, 18 people were killed when the building collapsed and many others were seriously injured. In recognition of the significance of the site at 233 Cambridge Terrace, CCDU has written to the families of those who lost their lives to inform them of the situation.

The property will become part of the new North Frame, which is a feature of the Christchurch Central Recovery Plan.

CCDU Director Warwick Isaacs says decisions are still to be made about the longer-term use of the site, but those

involved in the design and planning for the North Frame have been very mindful of what occurred at the PGC site, and this will be reflected in any decisions that are made.

"I have committed to keeping the families informed on the key decisions that are made about the site."

In July, CCDU announced the Crown had purchased the site where the Canterbury Television (CTV) building stood. It will be included in the East Frame.

The future use for the PGC and CTV sites is a separate issue to the planning for the Earthquake Memorial which is being led by the Ministry for Culture and Heritage. Engagement with affected parties in regard to the Memorial is underway in a separate forum. ♻️



**Roger Sutton**  
CERA Chief Executive

These beautiful spring mornings are lulling us into that feeling that winter is over. But as we know we can still get those unexpected cold winter blasts. So I want to remind you all again of our Make it Right programme which can help with emergency repairs, support and assistance. This programme is not just about keeping warm. It is also about reinforcing your right to live in a safe, secure and healthy home.

I am always struck by how stoic people are here in greater Christchurch. How often have you heard people say (after they have told you of their situation) that they can't complain as others are much worse off? I sometimes wonder if that is why there is often a reluctance to ask for and accept help when it is available.

For example, we recently found an elderly man who had been coping without a working toilet for a year. He didn't need to. Once we knew of the problem, his repairs were carried out quickly and highlight the sort of fast solution that the Make it Right programme can provide. The best referrals we have had to the programme have come from friends, neighbours and community groups. So now that you are out and about in this spring weather, go across to your neighbour, check out how they are doing and, if you are concerned, tell them about the emergency assistance we provide. And give them the Canterbury Support Line number **(0800 777 846)** – access to this service is free.

We also know that people can get stuck in this recovery process. The quantity of information needed in the rebuilding, repair and resettlement process can sometimes be overwhelming. That is why we have set up the Residential Advisory Service, an independent and free service to help home owners. We have had very positive feedback from those who have used this service, particularly around how people have felt empowered by the support and service provided.

It was great to see this advisory service recently endorsed in the Christchurch Press editorial, suggesting that 'faster, cheaper and less stressful resolutions' to the difficulties that can arise with earthquake repairs can often make more sense than lengthy litigation.

Finally, I also want to acknowledge the need across greater Christchurch for the return of basic community services and facilities. I absolutely agree that these are important and we work closely with the local authorities on progressing these as fast as possible. Priorities have to be made as not everything can be done at once. But I can assure you we are working hard on ensuring the greater Christchurch rebuild happens. ♻️

# Rangiora and Kaiapoi town centres open for business

## Shoppers are voting with their wallets in post-quake Rangiora and Kaiapoi town centres.

Despite lost retail floorspace and disruption caused by the need to remove earthquake-damaged buildings and to repair damaged infrastructure, retail spending in both Kaiapoi and Rangiora is trending well above pre-earthquake levels. This is according to the spending patterns of BNZ card holders in the two towns – see Figures 1 and 2 below.

Although the largest group of shoppers in the two towns is from within the Waimakariri district, significant numbers travel in from neighbouring Hurunui, and these visitors tend to spend more in each transaction. Rangiora and Kaiapoi shopkeepers' reports of a welcome increase in shoppers from Christchurch are borne out by the statistics which show a significant rise.

The increased spending also reflects the growing number of people setting up home in the district, with house-building running at 200 per cent above the long-run average. In Rangiora, spending on homewares and building supplies has almost doubled from a low in October 2010 to March 2013. Supermarket spending has risen 50 per cent between March 2010 and March 2013. Kaiapoi has seen corresponding rises in accommodation and hospitality (up 52 per cent) along with a 50 per cent increase in spending on fuel during the same period. The general rise in spending across the board is likely to have been triggered by the rapid development of new subdivisions in and around Kaiapoi. The rebuild of Blackwell's Department Store is almost complete and the number of new business startups in the district is also rising.

For more information, go to [www.visitwaimakariri.co.nz](http://www.visitwaimakariri.co.nz) (visitors) or [www.northcanterbury.co.nz](http://www.northcanterbury.co.nz) (businesses).



Rangiora High Street: Still a hub for shoppers in spite of earthquake disruptions.

**WAIMAKARIRI DISTRICT COUNCIL**

Phone: (03) 311 8900  
Web: [www.waimakariri.govt.nz](http://www.waimakariri.govt.nz)

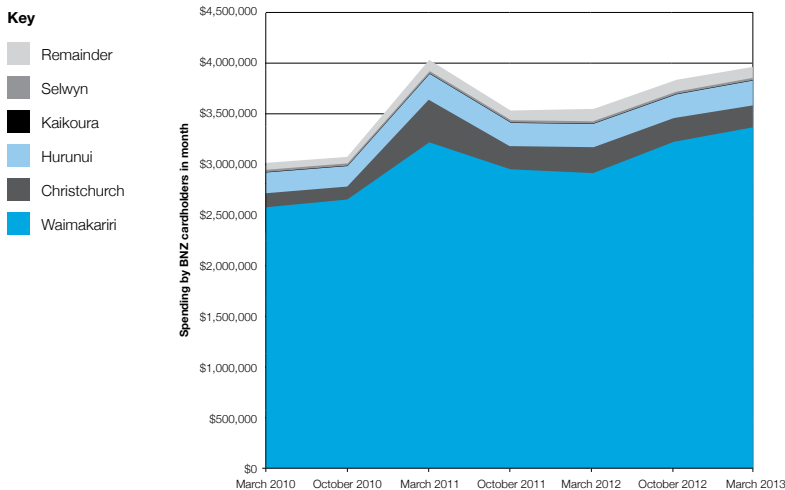

Figure 1: Value of spending in Rangiora by originating Territorial Local Authority

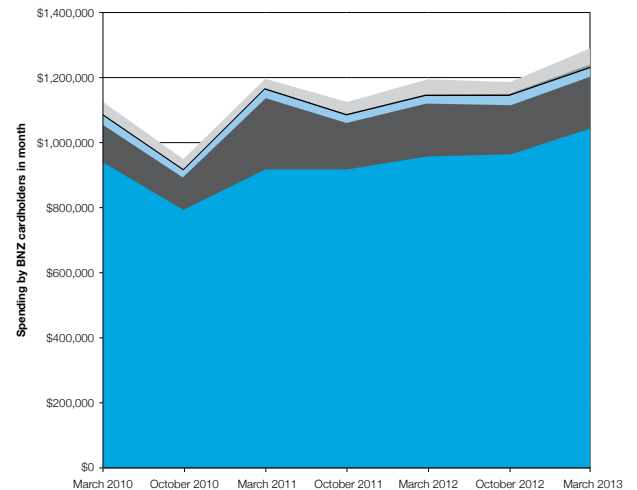

Figure 2: Value of spending in Kaiapoi by originating Territorial Local Authority

# Third anniversary of 2010 quake brings major claim milestones

The Earthquake Commission (EQC) reached two major milestones in September this year as greater Christchurch marked the third anniversary of the 4 September 2010 earthquake, which began a long sequence of damaging quakes.

First, EQC resolved all building claims for more than 100,000 houses, and reached close to the \$6 billion mark for total payouts and repairs. Resolution includes managed repair and cash settlement, with just over 70,000 still to repair or cash settle.

Second, repairs have been completed on more than 44,000 homes in the Canterbury Home Repair Programme, says EQC Chief Executive Ian Simpson.

"Each quake anniversary is a time to reflect on how Canterbury and individual Cantabrians are coping, and how far the recovery has progressed.

"It's understandable that there will be a lot of focus on those whose homes are not yet repaired or who do not yet have the certainty of a final settlement, and it is important these people's plight is not overlooked.

"However, to understand how the recovery is advancing, and to give some hope to those patiently waiting their turn, it's useful to look at how far we have come, and how much closer the light at the end of the tunnel is getting."

As well as achieving the building repair and settlement milestones, in 2013 EQC has:

- completed apportionment of all over-cap claims, allowing them to proceed to the private insurer for resolution
- made 178,000 customer contacts in the three months between May and July, providing information on the status of claims.

For the remainder of 2013, EQC will:

- settle all building claims under \$15,000, except where damage or multi-unit status requires managed repair
- complete all flat land damage assessments
- settle all Port Hills land claims.

In 2014, EQC will:

- settle all remaining land claims
- repair all remaining houses in the Canterbury Home Repair Programme
- resolve (cash settle or repair) all multi-unit building claims and other cash settlement claims.



Phone: 0800 DAMAGE (0800 326 243)  
Web: [www.eqc.govt.nz](http://www.eqc.govt.nz)



Artist's impression: Town Square and new library, community and technology centre.

**Find out more about these projects**

To find out more about these projects, go to: [www.selwyn.govt.nz/haveyoursay](http://www.selwyn.govt.nz/haveyoursay)

Copies of plans and submission forms are also available at Selwyn libraries, and from the Selwyn Aquatic Centre.

Drop-in sessions are being held for you to find out more about the Town Centre and Foster Park development and talk with Council staff about the plans. These are being held on:

- Wednesday 16 October – 5–8pm at the Council Headquarters, Rolleston
- Sunday 20 October – 1.30–4.30pm at Rolleston Community Centre

# Rolleston in the spotlight

Consultation is now open on a plan for Rolleston's development over the next 20 years. The plan covers the development of the Rolleston Town Centre and Foster Recreation Park.

Selwyn's population has increased significantly since the earthquakes and is projected to continue to expand. Over the next 30 years, it is expected that Rolleston will grow from around 8,000 to 9,000 people now, to between 18,000 and 22,000 people. With a population this size, Rolleston would be larger than today's Ashburton or Queenstown.

With growth comes the opportunity to develop the town centre and a main street as the heart of Rolleston, attracting people to shop and work in the town. There's also the opportunity to provide new facilities, parks and public places for people to enjoy.

This project includes the following proposals.

- Developing **Tennyson Street** as a two-sided shopping street which would become Rolleston's main street. It would be home to a range of shops and would have benches and attractive tree planting.

- Developing a **new library, community and technology centre** which would include multi-use spaces which could be used for performances, events, exhibitions, meetings, a business hub, a youth space and a wide range of other activities.
- Creating a new **Town Square** as a meeting place for locals and visitors, and a place for holding events and staging performances.
- Enhancing **Rolleston Reserve** with a playground and water feature. The location of a new shopping area and the new library, community and technology centre, the Town Square and shopping along Tennyson Street would bring more people to this area and encourage people to visit the Reserve.
- Introducing landscaping and pedestrian crossings, traffic lights and on-street parking to **Rolleston Drive**.
- Developing **Foster Recreation Park** as the largest sport and recreation park in Selwyn. The park will be able to be used by a range of sports codes for games and training, and by the community for walking and cycling, recreation and community events. The park will also include a children's play area.

The projects to implement the proposed plan will be staged over the next 20 years. Individual projects still need to be fully costed and a plan developed to fund these which could include using money from development contributions, rates and other funding sources like grants. Further consultation on projects and the cost to ratepayers will be carried out before any of these projects proceed.



## Primary and secondary school provision

The Minister of Education, Hon. Hekia Parata, has announced that new primary and secondary school provision will be available in Rolleston from 2016 (primary) and 2017 (secondary).

Consultation will run from September to the end of October 2013 which will allow you to have your say on how these new school facilities should be shaped.

For example, there could be new stand-alone primary and secondary schools; or the new primary or secondary provision could operate as an extension of an existing school; or there could be opportunities for shared governance and facilities. Michael Deaker from the Ministry of Education has arranged public consultation meetings at:

- Lincoln Events Centre on 9 October at 7pm
- Rolleston Community Centre on 17 October at 7pm

Michael Deaker will also be available at the Rolleston drop-in sessions to hear ideas about schooling options. Other ways to let him know your views are by emailing [michael.deaker@gmail.com](mailto:michael.deaker@gmail.com) or by calling 021 323 009.

## Foster Recreation Park Masterplan

- 1 Aquatic Centre
- 2 Arrival Sign, Artworks, Outdoor Fitness
- 3 Car Park
- 4 Car Park
- 5 Dog Park
- 6 Facility Sports Hub, Indoor Sports Courts
- 7 Foster Homestead, Dell and Play Equipment
- 8 High School Site
- 9 Kids and Youth Play Zones
- 10 Outdoor Sports Hub, Indoor Sports Courts
- 11 Recreation/Events Oval Hub
- 12 Sports Fields
- 13 Specimen Trees around Park and Avenues of Trees along Paths and Roadways
- 14 Wilderness Play amongst Specimen Tree Planting
- 15 Wilderness Play at former Quarry Pit
- 16 Potential cul-de-sac changes to Goulds Road



Map supplied by Boffa Miskell.



Phone: (03) 347 2800  
Web: [www.selwyn.govt.nz](http://www.selwyn.govt.nz)

# What's happening to the Clock Tower?

The Victoria Street Jubilee Clock Tower is undergoing repair. Fulton Hogan and the Christchurch City Council have been working together to align the tower so that it is level and straight.

Following the earthquakes the tower was not level, with a height difference of up to 35mm between the four supporting buttresses. But the damage could have been much worse if the strengthening work (adding steel bracing and rods) in 2003–2004 had not been done.

Although the tower is now level, current repair work will involve deconstructing the buttresses one by one so it may appear that the clock is unstable, but this is not the case. This is because the weight of the clock is not resting on the buttresses but on an internal frame which is hidden inside the structure so, even though you can't see it, the clock tower is secure.

Each buttress with its arch will be carefully deconstructed, a reinforced concrete core built and then, using the original stone, refaced. Each buttress and arch will be repaired sequentially around the clock until all four are complete.

Christchurch City Council has prioritised repairing this unique clock tower, treasured by Cantabrians for many years, under its Facilities Rebuild Programme.

For more information about the programme, visit: [www.futurechristchurch.co.nz](http://www.futurechristchurch.co.nz)

### The tower's timeline ...

- Designed by Benjamin Mountfort, constructed in Coventry, England and shipped across to Canterbury in pieces in 1860, the Jubilee Clock Tower is listed as a Group 2 protected building and registered as a Category I historic place by the New Zealand Historic Places Trust.
- Although originally designed to be part of the Provincial Council Buildings, the tower was too heavy even though two different locations within the building were tried. So it was put into storage in the Provincial yards and in 1876 it was transferred to the newly formed Christchurch City Council yards. The tower was in storage for 30 years. The clock itself remained in the Armagh Street tower until 1897.
- As a monument to Queen Victoria's Diamond Jubilee, a design by local architecture firm, Clarkson and Ballantyne, was selected to re-integrate both the clock and the tower and place it at the intersection of Manchester, Lichfield and High Streets. It remained there until 1930 when it was removed because it was believed to be a traffic hazard.
- And so it took up its current position on a reserve at the intersection of Victoria and Montreal Streets. ♻️



## SCIRT progress statistics

### Completed

<b>290</b>	projects totalling \$183.8 million
<b>42km</b>	fresh water pipe laid; 60% of damage repaired
<b>200km</b>	wastewater pipe laid; 30% of damage repaired
<b>12km</b>	stormwater pipe laid; 45% of damage repaired
<b>279,576sqm</b>	road pavement laid; 21% of damage repaired
<b>12,102</b>	face-to-face interactions about our work
<b>1,932</b>	work notices distributed to 489,553 addresses
<b>120</b>	projects totalling \$488 million under construction
<b>604</b>	pressure wastewater tanks installed

### In Pipeline

<b>57</b>	projects totalling \$266 million being estimated
<b>165</b>	projects totalling \$696 million being designed
<b>\$1.6 billion</b>	is the total value of work within the SCIRT rebuild programme



Phone: (03) 941 8999  
 Email: [info@scirt.co.nz](mailto:info@scirt.co.nz)  
 Web: [www.strongerchristchurch.govt.nz](http://www.strongerchristchurch.govt.nz)  
 Twitter: @SCIRT\_info



Phone: 03 941 8999  
 Web: [www.ccc.govt.nz](http://www.ccc.govt.nz)  
 Email: [info@ccc.govt.nz](mailto:info@ccc.govt.nz)

## UPDATE FROM ENVIRONMENT CANTERBURY

# Dealing with sediment part of earthquake recovery

Sediment in greater Christchurch's rivers and streams has increased following the earthquakes of 2010 and 2011, mostly from liquefaction silt.

The sediment and silt, which have built up on the bottom of rivers and estuaries, smother insects and plants and impact natural ecosystems and the food chain.

The proposed Natural Environment Recovery Programme, developed by Environment Canterbury with its strategic partners, addresses the silt and other ecological problems. The Programme includes projects to manage the sediment already in waterways as well as to prevent further discharge during rebuild activities.

Some of this work to protect waterways is already underway. Infrastructure repair contractors are working to minimise and limit the release of sediment, as required under their Environment Canterbury resource consents. Many rebuild site managers, in meeting these conditions, are also being proactive and innovative in minimising sediment discharge to nearby waterways.

### Bridge Street solutions

At Bridge Street in South New Brighton, Fulton Hogan is strengthening the bridge abutments by injecting cement grout into the ground.



Omar Seychell from Fulton Hogan and Fiona Nicol from Environment Canterbury discussing erosion and sediment control for the cement grouting at the Bridge Street site.

Through discussions around its consent conditions Fulton Hogan has uniquely and proactively installed a three-tier system to settle out the slurry and take it off site, protecting the sensitive estuary nearby.

These plans, projects and winning environmental solutions to sediment discharges benefit everyone, as well as protecting and restoring the natural environment and helping to build a flourishing and beautiful city for the future. ♻️



Phone: (03) 353 9007  
 Web: [www.ecan.govt.nz](http://www.ecan.govt.nz)

# Standing together to stop family violence

**There's a new name for Christchurch Women's Refuge as it expands its services in the post-earthquake environment.**

The community organisation is now known as Aviva. Demand for its services has significantly increased since the earthquakes with a 50 per cent increase in calls to its helpline and a 15 per cent increase in demand for its community services. The average length of stay in its safe house has doubled due to the shortage of onward accommodation.

In this context, the organisation has expanded its services. It still runs a 24-hour helpline, safe house and a range of community services for women and children at risk from domestic violence. But now Aviva also reaches out directly to men who are using violence against family members.

It created its new identity in partnership with design and advertising agency Strategy which did most of the work pro bono. It's one of a suite of partnerships that have given the revamped Aviva a lift as it spreads its expanded range of services into the Canterbury community.

Aviva Marketing and Funding Manager Julie McCloy describes it as a "whole of family approach – we provide a wide range of services to support individuals and families at any point of their journey towards a life free from violence".

Strategy Group Managing Partner Geoff Cranko says pro bono work is Strategy's R&D process in a way, providing a great opportunity for its 'creatives' to experiment.

"Sure, you have to have a profit focus. But we live in a community too. If we learned nothing else from the earthquakes, it's that we need to support and nurture our community.

"The earthquakes brought out the best and the worst in us. People like those working at Aviva are doing really great work out there, and if we can help, we're really keen to," says Geoff Cranko.

To find out more about Aviva, go to: [www.avivafamilies.org.nz](http://www.avivafamilies.org.nz) or if you or your family members need support, call **0800 AVIVA NOW (0800 28482 669)**.



*Cementing a partnership: Strategy and Aviva staff in May 2013, celebrating the 40th anniversary of Christchurch Women's Refuge, and its rebranding as Aviva.*

*From left: Strategy's media buyer Alicia Newton, Strategy Group Managing Partner Geoff Cranko, Aviva Marketing and Funding Manager Julie McCloy, and Strategy designer Kerry Argus.*

## Combined effort brings Scape Public Art to the central city

**It's hoped a recently unveiled artwork will bring new personality to the changing landscape of the Christchurch central city. *Tree Houses for Swamp Dwellers*, designed by Christchurch artist Julia Morison, has been installed at SCAPE 7 Art Central on the corner of Gloucester and Colombo Streets.**

The interactive piece has come about as a result of the combined efforts of a number of parties and sponsors, including Hawkins Construction. Hawkins played a role in planning, constructing and installing the sculptural project which can be re-sited in the future. Funding has also been supplied by Christchurch City Council and the Todd Foundation, with CERA giving approval for use of the land. Seventy per cent of SCAPE Public Art's activities are funded through Christchurch business and industry.

Hawkins Construction South Island Regional Manager Steve Taw says, "Helping build communities is part of our culture, and our staff have worked hard for six months to deliver this project."

Tony Sewell, Deputy Chairman, SCAPE Public Art Trust and Chief Executive, Ngāi Tahu Property Ltd, says what they're doing is important in making the city a better place to live in.

"The art creates energy and life in the central city, and our sponsors are showing their commitment to the city through their support."

*Tree Houses for Swamp Dwellers* will feature as part of SCAPE 7 which is running from 27 September to 9 November 2013.

For more information, go to: [www.scapepublicart.org.nz](http://www.scapepublicart.org.nz)



*Tree Houses for Swamp Dwellers: Hawkins Construction crew work to install the artwork.*



Tomorrow  
Starts  
Here.

**ANNUAL REPORT**  
**2012/13**

Full annual report, summary and financial statements available at [christchurchappealtrust.org.nz](http://christchurchappealtrust.org.nz)

**QUAKEAPPEAL.COM**

**Portfolio key**

- Large Permanent Projects
- Community Permanent Projects
- Economic Revitalisation
- Hardship / Spiritual & Faith
- Education / Youth
- Sport & Recreation
- Heritage & Culture
- Donor-directed ⊕

**UPDATE FROM THE CHRISTCHURCH EARTHQUAKE APPEAL TRUST**

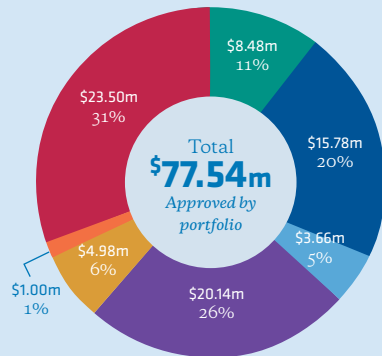
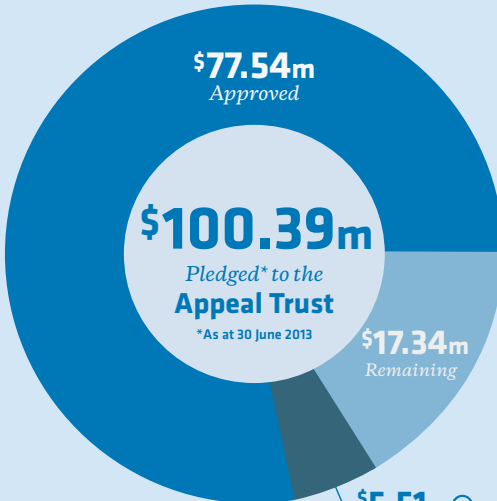

**GRANT HIGHLIGHTS** to 30 JUN 2013  
include funds towards:

**\$6.5 million**

Water attractions in the eastern suburbs ⊕

**221**

Youth workers supported ⊕

**69**

Sports clubs

**15**

Community centres ⊕

**1,700**

Kaiapoi children transported to swimming lessons ⊕

**13**

Cultural collections storage

**9**

Local business precincts supported

**17**

Tennis court repairs ⊕

**12**

Netball court repairs ⊕

**69**

Neighbourhood events held

**40,000**

Visitors to Quake City exhibition (to date)

**6**

Preschool/school playgrounds & turfs ⊕

**\$2 million**

Kaiapoi riverbank repair and redevelopment

**51,531**

Children attended 'Pools in Schoolz' ⊕

**593**

iPads for school children in the eastern suburbs ⊕

**10**

Community workers supported

