

Future Christchurch Update

The voice of the Canterbury rebuild

MAY 2015

Recovery Plan for Crown offers

Page 3

New bus facility set to open

Page 5

State-of-the-art public toilets for Christchurch

Page 7

Get In the Know at the new hub

Page 15

International football powerhouses Nigeria and Germany will be among the teams at FIFA U-20 World Cup New Zealand 2015.

Your chance to see football's finest in action

The FIFA U-20 World Cup New Zealand 2015 kicks off this month and sees world football's greatest young talent coming to our backyard to compete for the title of champion.

Christchurch Mayor Lianne Dalziel is looking forward to the opportunity to welcome the world to greater Christchurch.

"Broadcast to more than 200 countries and to an expected audience of up to 450 million people, we look forward to showcasing our city's recovery and showing the world it's happening in Christchurch.

"A warm welcome awaits the teams and visitors to our region as we look forward to the FIFA U-20 World Cup New Zealand 2015," Mayor Dalziel says.

Christchurch Stadium will hold nine matches and play host to the national teams of Germany, Brazil, Fiji, Uzbekistan, Honduras and Korea DPR.

Read more on page 6.

Inside:

- 3 Public to have their say on Crown offers
- 4 Feedback sought on transport projects
- 5 Bus Interchange opening soon
- 6 FIFA U-20 World Cup coming to Christchurch
- 7 Libraries and flash new toilets in the city
- 8 Ngāi Tahu development announced
- 9 Justice and Emergency Services Precinct update
- 10 Christchurch City Council & Selwyn District Council
- 11 Rangiora roading progress
- 12 Environment Canterbury
- 13 EQC & Housing NZ
- 14 SCIRT
- 15 In the Know Hub & Useful contacts



Publishing details

This publication is jointly produced by CERA and CCC.
 For editorial queries: editor@futurechristchurchupdate.co.nz
 For delivery queries: delivery@futurechristchurchupdate.co.nz

ISSN 2422-8664 (Print)
 ISSN 2422-9121 (Online)

This work is licensed under the Creative Commons Attribution 3.0 New Zealand licence.

This publication is produced in a way that allows for maximum recovery and recycling of materials, significantly reducing energy use, air and water emissions.



CANTERBURY EARTHQUAKE RECOVERY AUTHORITY

John Ombler
 Acting CERA Chief Executive

It is great to see the rebuild progress signalled in this publication with anchor projects such as the Justice and Emergency Services Precinct and the Bus Interchange, which is opening soon. The announcement of another major central city development that will house government workers is also a great step forward. In relation to the future of Victoria Square, we received a good level of feedback from the public engagement that closed recently. That feedback is now being used to help form a plan that we will take back to the community again later this year.

Minister for Canterbury Earthquake Recovery Gerry Brownlee recently

announced that a Recovery Plan will be produced that looks at the Crown offers to owners of vacant, commercial/industrial and uninsured properties in the residential red zone. Everyone will have the opportunity to have a say over the development of this Plan. We will be asking for public input soon. The aim is to have the Recovery Plan finalised and decisions made in relation to the Crown offer by the middle of the year.

I am pleased that I could confirm recently my ongoing commitment to my role as Acting Chief Executive at CERA. I have agreed to continue in the role until 31 December 2015. As you may know, CERA is moving

through a period of transition and I am committed to providing consistent and stable leadership. In terms of that transition, a plan is currently being developed to transfer responsibilities and powers from CERA to local government or other government agencies. I hope to be able to share more details about that in the coming weeks. ■



CHRISTCHURCH CITY COUNCIL

Dr Karleen Edwards
 Christchurch City Council Chief Executive

Thank you to all those who made formal submissions on the Long Term Plan. Public hearings on the Plan begin shortly and well over 500 people have asked to speak at them. If you want to follow proceedings, but can't attend in person, please watch via live-streaming on www.ccc.govt.nz. We will continue to keep you updated on progress ahead of the Council's adoption of the final Long Term Plan at the end of June.

For residents to make the most of our city, our transport network must be safe and efficient. We want to know what you think about several transport projects.

Riccarton Road is the busiest bus corridor in Christchurch, and a key

part of greater Christchurch's public transport network. Consultation opened last month on the proposed Riccarton Road bus priority and central Riccarton street improvements, which aim to help bus passengers arrive on time. Please send us your comments by Monday 18 May.

We are also seeking feedback on three proposed concept designs for central city transport changes supporting key anchor projects. They focus on three areas: Hospital Corner, sections of Durham Street/Cambridge Terrace and Manchester Street.

I am pleased to see the on-road work for earlier transport projects under the umbrella of *An Accessible City* is completed or nearing completion.

This is a significant step forward for the city's recovery and a great boost for residents. We are really beginning to see improved pedestrian- and cyclist-friendly facilities, smoother traffic flow and better bus routes to the new Bus Interchange. The upcoming opening of the new Bus Interchange will be a milestone for transport in Christchurch and I look forward to residents of Christchurch enjoying this facility. ■

Rebuild progress at a glance...

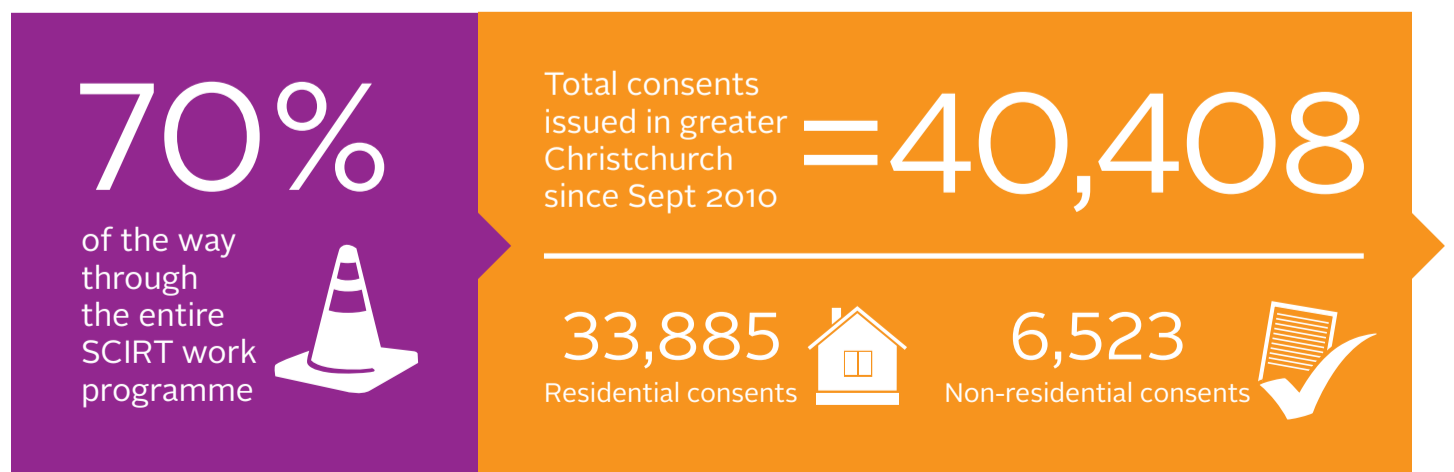

Source: Stronger Christchurch Infrastructure Rebuild Team (SCIRT), Statistics NZ.

Public to have their say on Crown offers

A process has been announced to give everyone a say on the Crown offers to owners of commercial/industrial, vacant and uninsured properties in the residential red zone.

Minister for Canterbury Earthquake Recovery Gerry Brownlee has asked CERA to prepare a Recovery Plan that looks at the Crown offers to property owners in these categories.

Following a legal challenge by the Quake Outcasts group, the Supreme Court directed that the decision on the offer to property owners in these categories should be revisited.

“The recent judgment from the Supreme Court has told us that a Recovery Plan is a good approach, and that public input is important,” says Minister Brownlee.

“If the process results in a larger revised Crown offer from that which has expired, then those owners who accepted the original offer will be eligible for a top-up of their payments,” Minister Brownlee says.



“The Recovery Plan process allows us to consider the different options, and for people to give their views based on what it means for the property owners, as well as the taxpayer and how people insure their properties.”

There will be two stages of public input in the development of the Recovery Plan, and CERA will be publicising those opportunities.

Owners of properties in these categories in the Port Hills red zones have not yet received an offer. An offer will be made to them on the basis of the outcome of the Recovery Plan but will not be less than the offer already made to those in the flat land red zones. Consideration will also need to be given to those who did not accept the earlier offer and those who had a reduced offer as a result of significant underinsurance.

It is expected the Recovery Plan will be finalised and decisions made in relation to the Crown offer by the middle of the year. ■

Questions and answers

You can find questions and answers about this on the CERA website: cera.govt.nz (search under **Crown offer background information**).

They include:

What is a ‘Recovery Plan’?

Under the Canterbury Earthquake Recovery Act, the Minister may direct that a Recovery Plan be developed for all or part of greater Christchurch. Recovery Plans can deal with any social, economic, cultural or environmental matter; or any particular infrastructure, work or activity. A recovery plan must be consistent with the Recovery Strategy for Greater Christchurch. There are two other active recovery plans – the Christchurch Central Recovery Plan and the Land Use Recovery Plan. A draft of the Lyttelton Port Recovery Plan is being developed.

What happens next?

A preliminary draft Recovery Plan will be developed and comments and any additional information will be sought from the public. This information will inform the development of a draft Recovery Plan, which will also be notified for public comment. Following receipt of those comments, the Minister may make any changes to the draft plan and decide whether to approve the plan.

When will we know the outcome of the Recovery Plan?

We want to progress this as quickly as possible for all involved. The Minister’s decision on the Recovery Plan is expected by the middle of the year.

How can I have my say?

The public will be able to provide written comments on the preliminary draft Recovery Plan and the draft Recovery Plan.

Meet the rebuild workers



Kane Reihana (24) Site engineer for Downer

Where are you from?

Taupo. I moved here about three years ago to be part of the rebuild. I worked for a consulting firm for the first two years doing geotechnical work and after that started doing contracting to get another perspective, to be on the other side of the spectrum.

What made you want to be part of the rebuild?

It's good work, good experience. There is a good variety of work as well. There's plenty going on so there's no shortage of things to look at and get involved with.

What excites you about the rebuild?

Progress and just keeping busy, watching things go up. Some new buildings in town are going up pretty quickly.

What challenges you about the rebuild?

It is cold in the South Island. I don't like the Crusaders. About the rebuild, I don't have anything to say really – it's just trucking along. There is still plenty to go.

Inner city travel and access improvements

The new travel network for the central city, contained in *An Accessible City*, the transport chapter of the Christchurch Central Recovery Plan, is taking shape. It offers improved traffic flow, more direct bus routes to the new Bus Interchange, a slower speed limit and improved facilities for both pedestrians and cyclists.



Cyclists can now enjoy cycle priority lights at the newly finished Hagley/Moorhouse intersection and use the Hagley Park shared path to Hospital Corner.

Five transport projects are either underway, nearing completion or completed.

Now you can have your say on the next three transport project proposals that are part of the Accessible City plan. The proposed changes are:

Hospital Corner

- The widening of Tuam Street (near Hospital Corner) including bus lanes and a new super stop.
- A new shared path for pedestrians and cyclists on St Asaph Street to connect Antigua Street, St Asaph Street and Hagley Avenue.

Durham Street/Cambridge Terrace

- A new short two-way section on Durham Street/Cambridge Terrace (between Lichfield and Tuam streets) to maximise access to the shops in that area.
- A new shared path to run along the river side of Durham Street/Cambridge Terrace.

Manchester Street (from Kilmore to Lichfield streets)

- Wider lanes and a speed limit of 30 kilometres per hour.
- Manchester Street to become a tree-lined boulevard, between Armagh and Lichfield streets, with improved streetscapes and tree plantings.
- Bus prioritisation and two bus super stops.

Consultation on these three projects closes on 26 May 2015.

Christchurch City Council and CERA will be holding drop-in sessions where people can speak to staff.

For more information and to make a submission, go to: www.ccc.govt.nz/haveyoursay

Powerful data behind travel planning

By 2041, as many as 50,000 cycle trips will be made to, from and within the central city each day using the new central city travel network.

This is a massive jump from the 11,700 that would be expected if the network stayed the same as it was before the earthquakes.

Computer modelling holds the key.

Back in 2004, the greater Christchurch councils and Ngāi Tahu started to develop the Urban Development Strategy, planning ahead to 2041. Part of this work was to produce the Christchurch Transport Model, which stores an incredible range of data on households, population, vehicle ownership, job information and more. Information on travel patterns helps planners design future transport networks for all kinds of travel.

Thanks to this work, when the Canterbury earthquakes happened, a computer model was ready to be used for *An Accessible City*.

Information on land use was captured in the Blueprint Plan for the central

city in 2012. Importantly, it was based on a scenario that would help the central city to rapidly recover by 2021 and continue to grow.

For example, the scenario assumes that central city employment levels will return to pre-quake levels by 2021 – about 47,393 jobs – and grow to about 63,000 by 2041. Planning for how these people will move about is vital.

Another computer modelling system, called the Christchurch Assignment & Simulation Traffic Model (CAST), has added further detail. It analysed the effects of the rapid recovery scenario by considering car and bus movement, journey times and potential for congestion. This analysis helped planners and engineers produce the best possible plan for a new central city travel network. ■

Comparison of daily trips made to, from and within the central city*

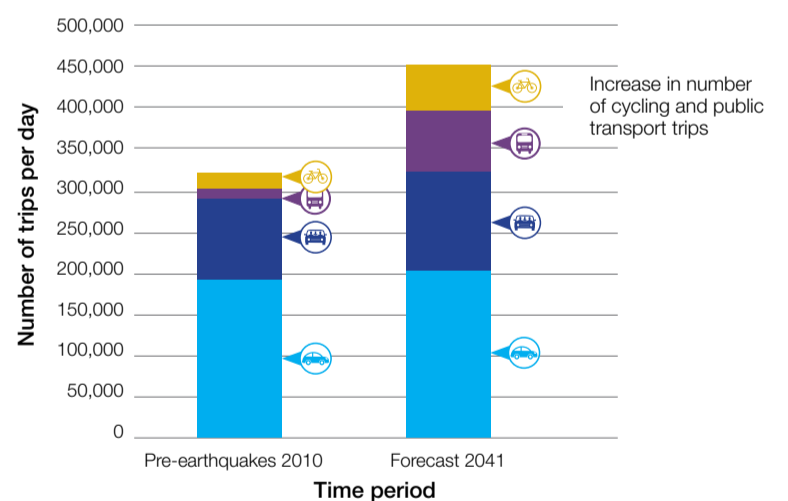

*excludes walking

Computer modelling – what does it show us?

By 2041, once *An Accessible City* is implemented, it is expected there will be a threefold increase in cycling and public transport use, while the number of car trips per day to, from and within the central city is anticipated to increase

only slightly compared with pre-earthquake levels.

Learn more about the Christchurch Central Recovery Plan and Accessible City at: ccdu.govt.nz/the-plan



Artist's impression: Stage two of the Bus Interchange (shown above) will be open this winter. By the year 2041 it is estimated that 70,000 people will pass through the facility each day.

Central bus facility operational soon

Progress in the Christchurch rebuild takes a huge step forward on Monday 18 May when the first stage of the new Bus Interchange becomes operational in the heart of the city.

It has taken just 11 months from the turning of the first sod to the point where the first stage of the interchange will be part of the city's day-to-day bus operations.

All Metro services will connect with the new Bus Interchange from Monday 18 May – either through the building itself or from a stop outside. At the same time, the temporary Central Station will shut down so that the next stage of construction of the Justice and Emergency Services Precinct can start on time.

Accessible through two Lichfield Street entrances, the Bus Interchange has an airport-style passenger lounge. Its automatic glass doors keep passengers completely separated from the bus circulation area, which is a key safety feature.

The architecturally designed building will have plenty of seating and be flooded with natural light. It will even feature a rain garden that captures and treats water before it is released into the drainage system.

Screens throughout the lounge will direct passengers to bus bays, while staff at the Metro information booth can offer personal help with directions.

The Bus Interchange is to be developed in two stages in order to get the city's new transport system working as quickly as possible. The anchor project's operational stage is on budget.

The rest of the interchange, including shops, the Colombo Street passenger lounge, the bold main entrance on the corner of Lichfield and Colombo streets, and secure bicycle parking, will be ready this winter.

Until the whole interchange is completed, the two sections will remain separate from each other for the safety of the public.

To see construction progress of the Bus Interchange over the past year, go to: <http://ccdu.govt.nz/projects-and-precincts/bus-interchange>

Cycling outside the new Bus Interchange

There will be a new, separated cycle lane outside the new Bus Interchange on Tuam Street. It will have specific cycle traffic signals and an additional safety feature – on-road orange flashing lights. The orange flashing lights warn cyclists

that their cycle-only traffic light is about to turn red. This warning is important as, when cyclists have a red light, buses have a green light and will turn across the cycle lane into the new Bus Interchange.

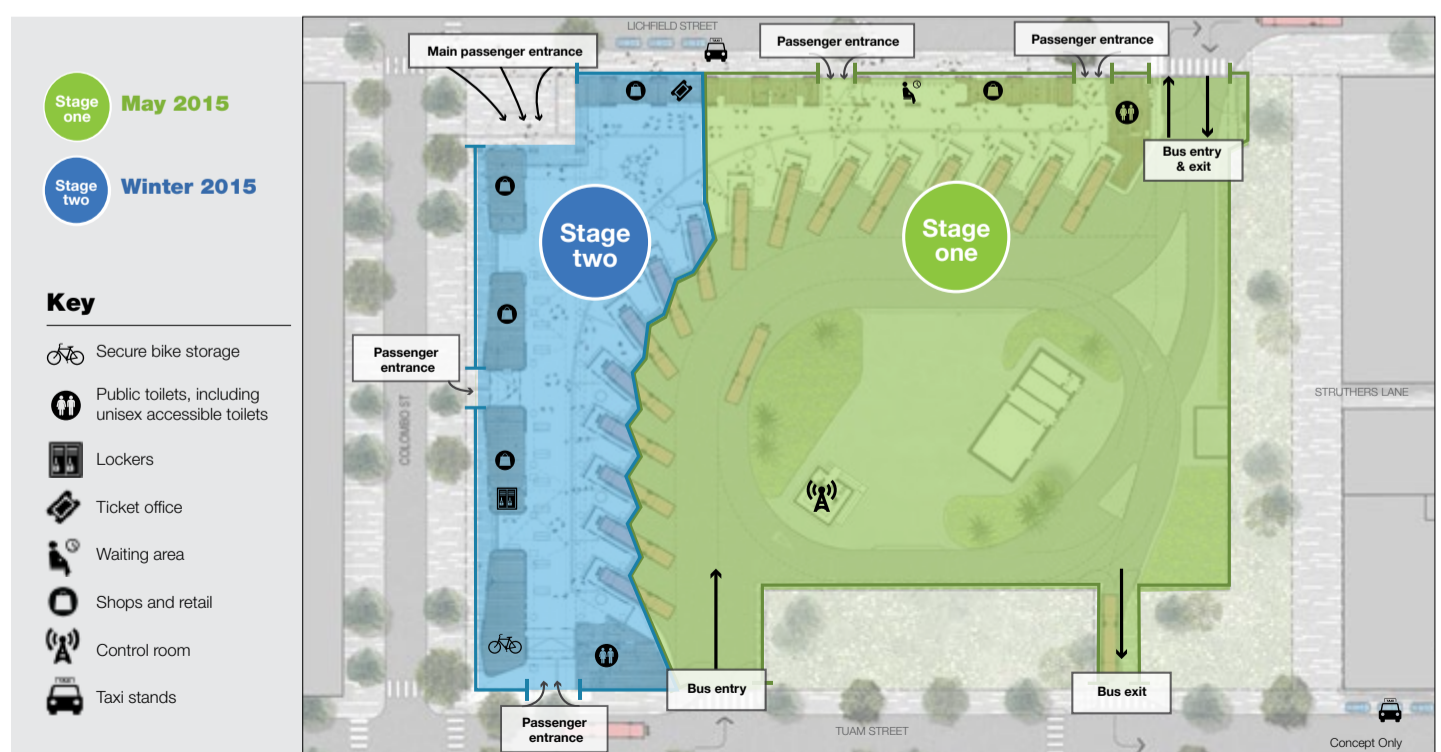
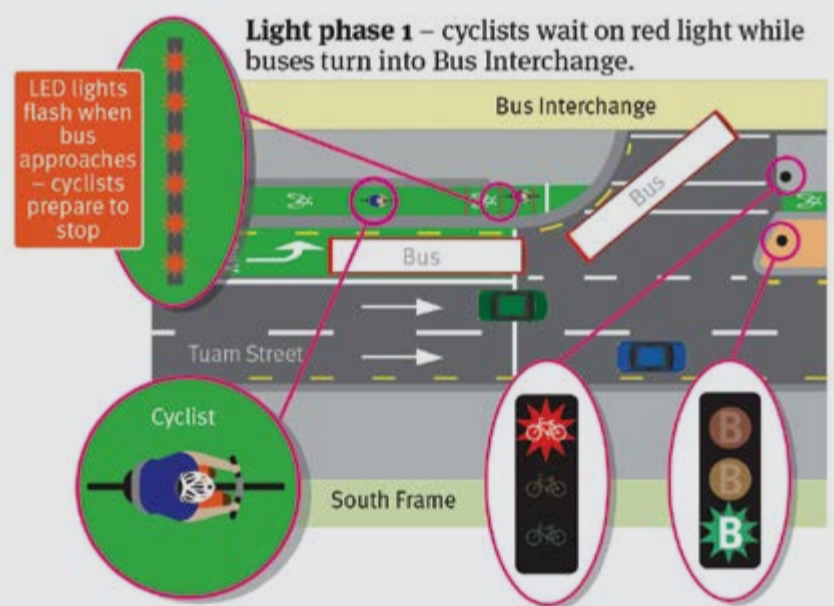

Stage one of the Bus Interchange opens this month.

Christchurch City Council in brief

Public hearings on Christchurch's Long Term Plan

Christchurch City Council will shortly begin public hearings on its Long Term Plan 2015–2025.

Councillors will hear verbal submissions at public hearings from 11–23 May in the Council Chamber at the Civic Offices (53 Hereford Street). The hearings will be live-streamed at: www.ccc.govt.nz

Although formal submissions closed on 28 April, residents can still take part in online discussions on the Council's Facebook page or tweet with #CCCLTP and councillors will receive summaries of opinions expressed.

Christchurch City Council's Long Term Plan videos have had more than 65,000 views online. The Council also held 14 public meetings across the city to discuss major issues covered in the Plan.

Proposed rates rises and asset sales have been hot topics.

The state of city roads has also generated a big response, and the Council has heard a lot about the need to repair and rebuild community facilities.

Councillors will take all this feedback into account when they adopt the Long Term Plan at the end of June.

For more information about Long Term Plan hearing dates and times, go to: www.ccc.govt.nz or phone 03 941 8999.

World War 1 the focus of speaker series in libraries

Christchurch Libraries are promoting a series of speakers' events as part of a programme to mark WW100, the World War 1 centenary from 2014 to 2018. The first speaker is Sarah Murray, Canterbury Museum's Curator of Human History, who will share some of the stories and history of special objects from the museum's collections. This will be held on 19 May at Riccarton Library from 6.30pm.

For information about Sarah Murray and other scheduled speakers, go to: <http://my.christchurchcitylibraries.com/ww100-centenary-commemorations> or phone 03 941 7923.



The Brazilian team will be among football's future legends showcasing the game in Christchurch soon.

Christchurch Stadium to take centre stage

Built in less than 100 days and located minutes from central Christchurch, the city's 17,000-seat temporary stadium is about to become football central for the FIFA U-20 World Cup New Zealand 2015.

AMI Stadium in Addington will be known as Christchurch Stadium during the tournament, which runs from 30 May to 20 June 2015.

The rectangular layout will create a great atmosphere and provide the best viewing experience for spectators at the nine local matches. With a first-class playing surface built to international standards, the Stadium provides the best possible opportunity for players to show off their skills.

FIFA U-20 World Cup New Zealand 2015 key facts

- Nine matches at Christchurch Stadium, Addington
- Broadcast to over 200 countries
- Global television audience of about 450 million
- 24 teams, amounting to 800 players and team officials

- Attracting 10,000–15,000 international visitors
- Up to 2,000 volunteers

Sports field upgrade work to support future generations

The FIFA U-20 World Cup New Zealand 2015 will give Cantabrians the chance to see and experience some of the most talented young footballers on the planet. Perhaps more importantly, it will also create a lasting legacy for future generations of players.

Christchurch playing fields at Ferrymead, Garrick, Avonhead and Linfield parks have been upgraded to deliver world-class training facilities for the teams participating at the FIFA U-20 World Cup in New Zealand. The improved pitches will be one of the legacies from the event.

Amateur players of all ages and abilities will now have the chance to play more football on better surfaces and, it is hoped, develop into the calibre of players like Ryan Nelsen and Winston Reid.

The improvements are testimony to what has been achieved through the contributions of FIFA, Christchurch City Council and other stakeholders.

"This work to upgrade facilities and playing fields will provide great benefits to our sporting community for many years to come and is something Christchurch can be proud of. It is another sign that this great city is on its way back after a tough few years," says Christchurch Mayor Lianne Dalziel.

To find out more, go to: fifa.com/nz2015

FIFA U-20 World Cup 2015: It's happening in Christchurch



Germany v Fiji
1pm Mon, 1 June 2015
Queen's Birthday



Uzbekistan v Honduras
4pm Mon, 1 June 2015
Queen's Birthday



Honduras v Fiji
4pm Thurs, 4 June 2015



Germany v Uzbekistan
7pm Thurs, 4 June 2015



Honduras v Germany
2pm Sun, 7 June 2015



Brazil v Korea DPR
5pm Sun, 7 June 2015

Round of 16 7:30pm
Thurs, 11 June 2015

Quarter-Final 1pm
Sun, 14 June 2015

Semi-Final 4pm Wed,
17 June 2015



2015 **Christchurch**
It's happening

HOST CITY



Eliza and Austin are looking forward to Te Hāpua: Halswell Centre becoming their new 'local'.



Construction underway on Te Hāpua: Halswell Centre. The steel frame is up and the roof has just been put in place.

Libraries popping up everywhere to meet community needs

For young Halswell residents Eliza (4) and Austin Bull (6), the current, cosy Halswell Library does the trick – but what happens as they get a little older and start taking up more space?

That's where Christchurch City Council's Major Facilities Rebuild Unit comes in – with construction underway on the new **Te Hāpua: Halswell Centre** just along Halswell Road from the current library. It is scheduled to open in November.

“The current Halswell Library was built in 1968, and is too small and outdated for present community needs,” says David Adamson, Director Council Facilities and Infrastructure Rebuild. “Even before the post-quake population shift, Halswell was growing at a rapid pace, and Te Hāpua is going to be a most welcome development for that community.”

The facility will incorporate the existing Halswell Aquatic Centre

alongside community spaces, a service desk and the 1,800-square-metre library.

“Hubs like Te Hāpua aren't just convenient for local residents – they also mean efficiency and savings on the Council's part. We're moving towards combining libraries, recreation and sports, customer service and community facilities on a wider scale,” Mr Adamson says.

Bishopdale Community Centre and Library is to be built on the site of the former Bishopdale Creche in Farrington Avenue. The Fendalton–Waimairi Community Board considered the results of a site evaluation process, including an endorsement from a Joint Working Group of community

representatives and public support for a replacement community centre and library on the site. It replaces the facility in Bishopdale Mall, which is closed and has been assessed as uneconomic to repair.

A final concept design for the new **Sumner Community Facility** has been completed. A workshop in November last year gathered residents' feedback, which has been taken into account in the updated concept design. A Joint Working Group, which includes a number of Sumner residents, has also had input into the concept design.

Residents can check out the concept designs on display at the Wakefield Avenue site or by visiting

futurechristchurch.co.nz

It is expected that construction of the new facility will begin in mid 2016 and be completed in 2017.

For more information, go to:

www.ccc.govt.nz ■

“We're moving towards combining libraries, recreation and sports, customer service and community facilities on a wider scale.”

David Adamson

Taking bog-standard to exciting new levels

The humble public toilet will no longer be the place you only visit in an emergency. Once Christchurch City Council has upgraded its earthquake-damaged and below-code toilets across the city and Banks Peninsula, you might not want to leave them.

“I wouldn't go that far,” says Darren Moses, the Council's Community Facilities Rebuild Unit Manager. “But they're going to be state-of-the-art and a big step up from the older models. Being caught on the hop in Christchurch will never be the same.”

Concrete and stainless steel, vandal-resistant and with solar-powered lighting, the toilets aren't just easier to run and clean – building them is more cost-efficient too.

“They're being manufactured in Auckland, then shipped down to Christchurch,” Mr Moses says. “We create the concrete pad on the site,

with all services connected and ready to go, and then we simply deliver the facility and fit it on top.”

The first toilets will be introduced in South New Brighton Park by June. Next up, Avon Park, Awa-iti Sports Grounds, Duvauchelle Showgrounds, Le Bons Bay, Bexley Park, Cashmere Valley Reserve and Heathcote Domain will get their top-quality toilets by November. Existing toilets at Middleton Park, Halswell Domain and Hagley Netball Courts will be strengthened.

For more information, go to: **www.ccc.govt.nz** ■



No more unsightly toilet walls! New toilets being installed near playgrounds, like the one at South New Brighton Park, will feature a colour scheme to match the playground equipment.



Artist's impression: Ngāi Tahu Property's new riverside office development will cater for 350 government workers by early 2017.

Fourth new central city site confirmed for government workers

A major new development announced for Christchurch will bring more government workers into the central city.

By early 2017, about 350 staff from the Ministry of Education, Housing New Zealand Corporation and the Ministry of Health will have a new home in a 8,500-square-metre office building to be constructed on the site of the former central police station.

The riverfront building on the corner of Hereford Street and Cambridge Terrace will be part of a wider development on the city block by Ngāi Tahu Property.

"This is the fourth new central city building we have now confirmed with a lease to house public servants in central Christchurch," Minister for Canterbury Earthquake Recovery Gerry Brownlee says.

"Last year we announced that 1,100 staff from 13 government agencies would move into three new central city buildings, in addition to 200 Inland Revenue staff already working in the Mid City Building above Ballantynes.

"This demonstrates the Government is continuing to back the recovery of central Christchurch. It is another positive step forward for a central city rebuild that now has huge momentum," says Minister Brownlee.

State Services Minister Paula Bennett says having the workers close to Christchurch City Council and other government agencies based in and around the Retail Precinct will be a more effective way of working for the people of Christchurch.

All four buildings that will house government staff will also include space for private sector tenants and car parking.

It is expected the new building on the former police station site will be ready for its tenants in February 2017. The 1,100 staff from the 13 other agencies will be in the three other buildings – Grand Central and BNZ Centre stages I and II – by the end of 2016. ■



**AVON RIVER
PRECINCT**
TE PAPA
ŌTĀKARO

Ōtākaro/Avon River

Work to clean and revitalise the Ōtākaro/Avon River in Christchurch's central city recently completed.



10,000
sand

10,000
new plants



18
months
of work

A 2.9 kilometre stretch of river was cleaned and revitalised









Christchurch Justice and Emergency Services Precinct takes shape

With close to 100,000 construction hours now spent on it, the massive Christchurch Justice and Emergency Services Precinct is really taking shape.



The north-west view of the Precinct from the corner of Lichfield and Durham streets.

The Christchurch Justice and Emergency Services Precinct brings together all justice and emergency services in one purpose-built, world-class precinct in central Christchurch. Once complete, an estimated 2,000 people will work in or use the 42,000-square-metre precinct daily. Agencies are due to move into the Precinct in early 2017.

At the peak of construction, 500 people will be working on site each day. It is the largest multi-agency government co-location project in New Zealand's history and the first major public building complex the Government will complete in Christchurch since the earthquakes of 2010 and 2011.

The Precinct consists of three buildings: a Justice Building, an Emergency Services Building and a parking building for operational vehicles.

Built to Importance Level 4, it has special post-disaster functions, and base isolation technology. Level 1 of the Precinct will sit on 50 lead rubber bearings and 83 slider bearings, which minimise the movement of the building in a major earthquake. For example, in an earthquake the size of the February 2011 shake, the building would only move 250 millimetres sideways.

Twenty steel columns have been installed in the Justice Building since installation began on 22 February 2015. Each steel column is 18 metres long and attached to a steel node and either a base isolator or a slider on top of the concrete column. Sixteen of these steel columns have been used in the Tuam Street Justice Building, which is well underway. In the coming weeks, the pouring of the concrete floors for this stage of the Precinct will begin.

Work has also started on the next stage of the Justice Building at the Durham Street South end. Steel nodes are already in place and the first steel columns are being attached to these. In the Emergency Services Building, pre-fab concrete walls and block walls have been installed on the ground floor.

To make way for the next part of construction, the fences surrounding the Precinct site will be extended on 1 June to allow work to begin on the secure laneway and parking building for operational vehicles.

You can follow the progress of the Justice and Emergency Services Precinct on Facebook: www.facebook.com/JusticeandEmergencyServicesPrecinct



View of the site on 29 April 2015, showing the columns and base isolators.

Christchurch Justice and Emergency Services Precinct  Construction hours (as at 31 March 2015) = **93,140**



Christchurch City Council in brief

Finding the balance

By now, if you're a Christchurch resident you'll have received a district plan review newsletter in your letterbox or post box.

If your property is directly affected by any of the stage two changes, you'll also have received a letter telling you about this and how to find out more.

Whether or not your property is directly affected, and whether you support or object to what is being proposed, Christchurch City Council would like to know your thoughts. Submissions can be made on the stage two proposals until 29 June 2015.

Drop-in sessions are being held across the district in the second half of this month. Dates, times and venues are all outlined in the district plan review newsletter and at www.ccc.govt.nz/districtplanreview

These are informal sessions where you can pop in and talk directly with one of the Council's planners about possible effects on your property or your neighbourhood. You can also be shown how to make an electronic submission if you wish. For more information, call 03 941 8999 (or 0800 800 169).



Be part of Beca Heritage Week

Do you have a great idea for a Beca Heritage Week event?

Community groups, businesses and individuals are invited to attend a public meeting on 11 May to learn what the theme will be for Beca Heritage Week, 9–26 October 2015. Information will include how to submit an event and apply for funding assistance. Beca Heritage Week project team representatives will give tips on how to create an engaging event and share highlights from last year's Heritage Week. The meeting will be held in the Christchurch City Council Function Room, 53 Hereford Street, from 6–7pm on 11 May. Refreshments will be provided.

Riccarton Road bus priority – have your say

Consultation on the proposed Riccarton Road bus priority and central Riccarton street improvements opened last month and runs to 18 May.

When roads are congested, it helps to give priority to vehicles that can move people efficiently. Christchurch City Council is proposing two options for bus priority measures along

Riccarton Road from Clarence to Matipo streets, and one option from the Deans Avenue/Riccarton Road intersection to Clarence Street.

Depending on which of the two options the Council approves, Riccarton Road bus priority measures may include:

- part-time or full-time bus lanes
- traffic lights giving priority to buses at some intersections
- pedestrian safety
- signal-controlled pedestrian crossings
- improved cycle and pedestrian facilities
- improved bus stop and bus shelter facilities
- changes to parking arrangements.

Christchurch City Council wants to know what you think about the two options. To find out more, or to get the details of a drop-in session, go to: www.ccc.govt.nz/haveyoursay



Have your say on bus priority measures proposed for Riccarton Road.

Selwyn speed limits changing

Speed limits on major routes connecting Prebbleton with Christchurch city and in some townships in Selwyn have been reduced.

One of the major changes is that speed limits have been reduced from 100 to 80 kilometres per hour on many of the main routes from around Prebbleton to Christchurch city. These roads are becoming increasingly busy due to population growth in the Selwyn district, particularly since the earthquakes. The lower speed limits are to improve road safety, given the number of busy intersections along these roads.

The new speed limit of 80 kilometres per hour will apply to parts of Shands Road, Waterholes Road, Ellesmere

Road and Trices Road, and all of Hamptons Road and Marshes Road. It will also apply to a number of other roads around the Prebbleton area.

Speed limits have been reduced on some roads in the following townships as well: Burnham, Darfield, Doyleston, Hororata, Leeston, Lincoln, Prebbleton, Rolleston, Selwyn Huts, Sheffield, Southbridge, Springston, Tai Tapu and West Melton. Most of the changes are a result of the growth of townships as residential speed limits have been extended to take in new subdivisions or housing.

The changes to speed limits are enforced from the time when signage is installed so motorists should look out for new signs. For more information, go to: selwyn.govt.nz

Contact details:

selwyn.govt.nz
03 347 2800 or 03 318 8338



How do you think the rebuild is going?

We spoke to people on the street about how they see rebuild progress in greater Christchurch. They gave us their thoughts on what is working and what challenges them on a day-to-day basis.



Lisa Hall, Ohoka

What excites you about the rebuild?

In Rangiora, the fact that Farmers is being rebuilt and also the place just up the road where they are building the Robbies. I am happy to see them just generally opening up the [Rangiora] High Street so that we can walk up both sides of the road on the pavement, without having to cross the road. It is just good for the residents really to bring the local businesses back.

What do you think could be done better?

A bit quicker maybe? Just coming from the UK it seems to have taken an awfully long time – more than four years after the earthquakes and we are still living like this.



Lindsay Eason, Swannanoa

What excites you about the rebuild?

Here in Rangiora, it's moving along but it needs to, to keep people coming in. Town is certainly a lot busier than it used to be. A lot more people have moved out here since the quakes.

What do you think could be done better?

I think the [Rangiora] High Street needs to be opened up a bit more. Parking-wise it's quite difficult and if you are whizzing in to get something and out again, it takes a wee bit of time. That needs to be addressed, and traffic flow.*

**See below for an update on roading changes in Rangiora from Waimakariri District Council.*



Joan Whillans, Kaiapoi

What excites you about the rebuild?

I have avoided the city because it has been so demoralising, but now it is positive to see the new buildings appearing. There is some wonderful architecture going on, and I love that. It is a long, long process, but it is exciting to see what is happening.

In Kaiapoi people are back on the street, we have new businesses, it is just vibrant. People are complaining that they can't get a park and that's really good because before you could pick your park. It was really quiet, and nobody was around. It's all picked up and the future looks very positive.

What do you think could be done better?

I'd like to see the empty spaces of the red-zoned in Kaiapoi really well used – as a park or something that people can enjoy. There is talk about food forests and other projects. There's so much that we can do in Kaiapoi to make it a destination on lots of levels.

Rangiora – let there be lights

As a launchpad for the redesign of the Rangiora town centre's main street, High Street, the town now has its first set of traffic lights.

The traffic lights have been installed at the eastern end of High Street, where it intersects with Ivory/Ashley streets. The intersection, known locally but unofficially as 'Red Lion Corner' after a now-closed hotel on one of the corners, has been re-aligned to increase access to High Street, enhance the pedestrian journey, connect the east and west of the town centre, and allow a smoother run from north and south.

As the name 'Red Lion Corner' related to a former landmark, some have suggested renaming it 'Cenotaph

Corner' given that it is home to Rangiora's cenotaph. It's an idea that the local Returned Services Association supports.

The 'switch on' of the first traffic lights provides more than signals for traffic: it is also a symbolic signalling of the start of a major re-organisation of the core of High Street into a two-way street.

The High Street project will be completed in three stages to avoid disrupting traffic as much as possible and to allow private development in the immediate area to go ahead at the same time.

Stage One was completed on Friday 17 April. The previously one-way street, has become two-way from Cenotaph (Red Lion) Corner west to Percival Street.

Stage Two will address High Street between Victoria and Percival streets. Some kerbs will be re-aligned to allow for turning and passing traffic when the flow is switched to two-way and the current angle parking will be replaced with parallel parking. A paved, raised platform will be constructed as a feature at the Percival/High Street junction. Work on this stage is scheduled from May through to July this year.

The third stage between Percival and King streets, provisionally scheduled from September this year, will involve the removal of the temporary retail units installed outside the Council building after the 2010/2011 earthquakes, and the re-landscaping of that area. Kerb build-outs in this area will also be removed and parallel parking installed.

Rangiora's second set of traffic lights is scheduled to follow later this year in Southbrook to coincide with the construction of the new Pak'nSave supermarket. ■



Contact details:
waimakariri.govt.nz
 03 311 8900
info@waimakariri.govt.nz

Key
■ Stage One
■ Stage Two
■ Stage Three
■ Buildings
● Street Tree

Land Use Recovery Plan review

During May, Environment Canterbury is asking the public and stakeholders for feedback on the effectiveness of the Land Use Recovery Plan (LURP) and the 50 actions contained in it.

The consultation period began on 30 April and ends on 29 May 2015. It is the first of a two-part consultation process.

The Land Use Recovery Plan was gazetted in December 2013, with provision for monitoring and review. A LURP Monitoring Report was completed in March 2015. Its observations on how the 15 outcomes identified in the LURP are being achieved are valuable in reviewing the LURP.

Based on the monitoring report, the public will be given the opportunity to respond in relation to each outcome. People can also comment on other matters addressed by the LURP.

Feedback received as part of this consultation process will inform a LURP Review document. As well as summarising community and stakeholder feedback, that document will include the conclusions and recommendations of the Review and any proposed amendments to the LURP. The second part of the consultation process will take place in August and focus on any proposed amendments to the LURP.

The final Review document will be presented to the Minister for Canterbury Earthquake Recovery, Gerry Brownlee, by 30 September. He will determine if any further action is required.

Environment Canterbury will prepare the LURP Review document with its strategic partners – Christchurch City Council, Selwyn District Council, Waimakariri District Council, Te Rūnanga o Ngāi Tahu, New Zealand Transport Agency and Canterbury Earthquake Recovery Authority. ■

Contact details:

🏠 ecan.govt.nz

☎ 03 353 9007



What is the LURP?

The LURP is a statutory document developed to provide direction for residential and business land use to support recovery and rebuilding over the next 10 to 15 years. It sets a policy and planning framework necessary to rebuild existing communities, develop new communities, meet the land use needs of businesses and rebuild and develop infrastructure to support these activities. Natural hazards and environmental constraints are taken into account.

For more information and to find out about making a submission, go to: ecan.govt.nz/LURP

Preliminary draft Lyttelton Port Recovery Plan out for public consultation

Last month, Environment Canterbury held a series of well-attended public meetings to answer questions and encourage people to make submissions on the preliminary draft Lyttelton Port Recovery Plan.

If you've missed the public meetings, you can still drop into Environment Canterbury's PORTacabin on the corner of Oxford and London streets in Lyttelton on Thursdays 10am–2pm or Saturdays 10am–12.30pm until 15 May 2015.

Without this Plan, the rebuild of the Port would need around 100 resource consents from Environment

Canterbury and Christchurch City Council. This would mean a slow and uncertain recovery process. Therefore, Environment Canterbury asked the Minister for Canterbury Earthquake Recovery to consider the best approach to rebuilding the Port, including how to involve the community in decision making and ensure appropriate environmental safeguards.

In June last year, the Minister directed that a Lyttelton Port Recovery Plan should be developed.

Proposals in the Plan include reclaiming an extra 27 hectares of land at Te Awaparahi Bay for a new container terminal and providing for the repair or rebuild of many of the wharves in the inner harbour. Another focus is to ensure better public access to the waterfront while limiting the

redevelopment of Dampier Bay so it doesn't compete with Lyttelton's town centre.

The Plan is open for submissions until 11 May 2015, after which there will be a public hearing starting from 2 June.

Check out the plan and make a submission online at: ecan.govt.nz/port ■

Discover how locals are making their mark.

Download the free ChCh Story app today.

"The resilience shown by all Cantabrians has been inspiration enough to make the locals do extraordinary things."

ALEX REESE FOUNDER, CRICKET LIVE FOUNDATION

futurechristchurch.co.nz

2015 Christchurch It's happening

Deadline for managed repair decision – 1 June 2015

The Earthquake Commission (EQC) is asking Canterbury home owners to confirm whether they wish to be part of the Canterbury Home Repair Programme (CHRP), so EQC can commit adequate resources to complete the programme.

To get clarity, EQC has set a deadline to close the CHRP to all new customers and repairs by Monday 1 June 2015.

From that date, no further customers will be accepted into CHRP unless they have a prior agreement with EQR or EQC, and previously cash-

settled customers will not be able to opt back in to the programme.

General Manager Customer and Claims Gail Kettle says customers whose repairs are underway do not need to do anything.

“The 1 June deadline is for those who, for various reasons, have not been ready for our contractors to begin work on their properties, or who may still be in negotiation with EQC.

“We know everyone’s situation is different, and we’ll be attempting to contact all outstanding customers

“We know everyone’s situation is different ... so we want to find the best fit for each customer.”

Gail Kettle

individually to resolve their queries and help them decide. There are only a few thousand repairs left to do, with many already underway, so we want to find the best fit for each of the remaining customers among the options available under the Earthquake Commission Act 1993,” Ms Kettle says.

“We’re also offering a no-obligation scope of the works needed for each home.”

The 1 June deadline will have no impact on customers who have confirmed a start date for repairs, who have post-repair issues, or whose properties may have increased flooding vulnerability, as land claims will be treated separately.

After EQC has tried to contact customers, if they have not decided or cannot be contacted by 1 June 2015, EQC will assume they do not want to have their property repaired by CHRP. A cash settlement will be one option available to such customers under the Act.

Call us to discuss your situation on 0800 DAMAGE (0800 326 243). ■

If you prefer to get support from an independent agency:

- contact the Residential Advisory Service by phoning 0800 777 299 or 03 379 7027 or email: info@advisory.org.nz
- visit the support agencies at the In the Know Hub, open Monday to Thursday until 25 June, at Eastgate Shopping Centre.



From 1 June, no further customers will be accepted into Canterbury Home Repair Programme unless they have a prior agreement with EQR or EQC.

Contact details:

- 🏠 eqc.govt.nz
- ☎ 0800 DAMAGE or 0800 326 243



Community input improves Housing New Zealand plans for Aranui

Housing New Zealand has revised its major plans for new homes in Aranui after extensive engagement with the local community.

It worked closely with tenants, neighbours and community groups to consult on proposed developments on five large sites near Wainoni Park.

Original plans proposed up to 79 new two-storey, adjoining houses across the five sites, with no garages.

A series of drop-in sessions and workshops and ongoing dialogue with key stakeholders, including Aranui Community Trust Incorporated Society (ACTIS), sought the community’s feedback on the proposals.

As a result, these plans have been improved with:

- four fewer houses overall
- nine fewer two-storeyed houses
- more stand-alone houses
- garages for 25 three- and four-bedroomed houses
- no laundries upstairs
- removal of through roads and internal walkways on sites and use of rumble strips for safety

- using pool fencing to provide see-through street frontages, with 1.8-metre backyard fencing, for security and privacy.

ACTIS Chairman Rob Davidson says the Society is very pleased with the revised plans and is grateful to Housing New Zealand for entering into community consultation in such a meaningful and constructive manner.

Mr Davidson says he is confident the development will provide good-quality housing and help to make Aranui a great place to live now and in the future.

“The new houses are desperately needed in the community and we are confident that the design features contained in the development will meet the needs of both the occupiers and the wider Aranui community for many years to come.”

Housing New Zealand’s Canterbury Earthquake Recovery Programme General Manager Paul Commons says the community feedback has been

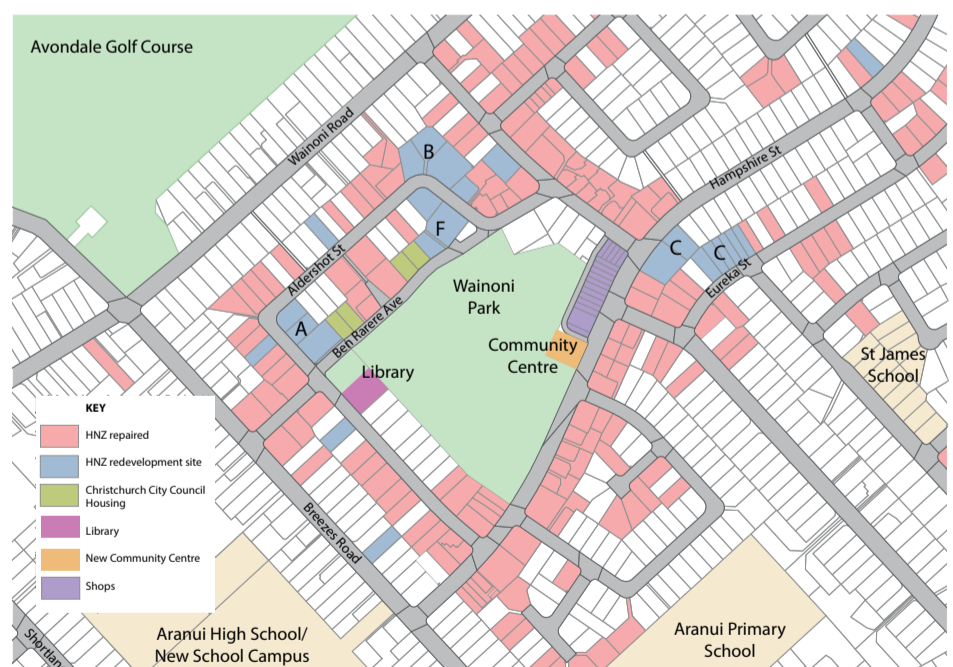

The five major development sites in Aranui, close to Wainoni Park, where Housing New Zealand plans to build new state housing this year.

key to getting a better outcome for those larger sites.

Meanwhile, building continues on stand-alone sites in Aranui, and Housing New Zealand has almost completed its earthquake repairs programme in the area. ■

Contact details:

- 🏠 hnzc.co.nz
- ☎ 0800 801 601



SCIRT getting bridges back in business

The Stronger Christchurch Infrastructure Rebuild Team (SCIRT) is around 75 per cent of the way through its bridge repair programme.

What's starting?

Carlton Mill footbridge

People who walk, cycle or run across the Carlton Mill footbridge in Little Hagley Park will have a new bridge to cross in time for summer.

SCIRT's McConnell Dowell team starts work here this month. The existing footbridge, used by pedestrians and cyclists, was badly damaged in the earthquakes and needs to be demolished and rebuilt.

Looking out for a slice of history

The team will be keeping a close eye out for historical items when it removes the existing bridge. The abutments date back to 1908, so archaeologists will be on hand to document any old treasures found.

New handrails

The rebuilt footbridge will have new handrails especially designed to fit in with the area surrounding the bridge. The local community provided input to the design to ensure a good view of the river.

Alternative routes

The work is expected to take around six months. During this time pedestrians and cyclists can use Helmores Lane bridge as a detour, or continue down Carlton Mill Road towards Bealey Avenue.

Hagley Park Armagh Street bridge

People who use the Botanic Gardens car park will need to reach it along a special temporary access road via Riccarton Avenue when repair work on the earthquake-damaged Armagh Street bridge in Hagley Park starts this month.

It's all happening underneath

SCIRT's McConnell Dowell team is repairing the bridge, which was built in 1885. Those walking past while the work is going on won't see much activity happening on top of the bridge, as the majority of the repairs will be done under it.

During the first stage, the team will remove bricks from underneath the bridge and inject grout into cracks. They will then put the bricks back in place.

The second stage of work will involve cross-pinning metal bars across the cracks to help strengthen the bridge.

A dam and scaffolding will be set up along one side of the bridge to create a dry space for the team to work in. This will involve a dewatering system and pumps. When the team has finished repairing the cracks on one side of the bridge, the dam and scaffolding will be shifted to the other side so that side can then be repaired.

Finally, the team will repair a number of the pillars on the side of the bridge that moved during the earthquakes. Repairs are expected to take around six months.

Temporary access to car park

The bridge will remain open to cyclists and pedestrians while under repair. However, it will be closed to motor vehicles. This is because several layers of bricks need to be removed as part of the repair, requiring weight restrictions on top of the bridge.

Vehicles will still have access to the nearby car park so that they can easily get to the Botanic Gardens and Hagley Park. They can access the car park via a temporary road from Riccarton Avenue normally used for service vehicles only. Use the entrance to the croquet and tennis clubs and follow the signs.

Please watch for cyclists and pedestrians when using the temporary road. Pedestrians may need to cross the road and cyclists will be merging with traffic. Please keep to the speed limit and drive to the conditions.

After the repairs are complete and the bridge re-opened to vehicles, the temporary access road will be removed and the area restored to its former condition. ■

Contact details:

strongerchristchurch.govt.nz

03 941 8999

info@scirt.co.nz



What's finished?



South New Brighton school pupils celebrate progress on the Bridge Street bridge.

Bridge Street bridge re-opens to heavy vehicles and pedestrians

At the end of March, heavy vehicle weight restrictions were lifted and pedestrian access was officially re-opened on Bridge Street bridge, South New Brighton.

SCIRT's Fulton Hogan team held a community celebration to mark the occasion. Students from nearby South New Brighton School were jumping with joy to be among the locals who were the first to walk across the repaired bridge.



Associate Minister for Canterbury Earthquake Recovery Nicky Wagner leads community members across the Antigua Street footbridge at its re-opening on 30 April.

Antigua Street footbridge back in action

Good news for people who walk and cycle around Ōtākaro/Avon River near the hospital. Late last month, the Antigua Street footbridge near the Antigua Boatsheds re-opened.

There was some spectacular viewing while SCIRT's Downer

team repaired the bridge. A crowd gathered to watch on a chilly evening last July as the curved steel structure was carefully removed by crane and taken away for repair. In February, when the steel structure was craned back into position, a crowd once again gathered to watch the event. ■



Earthquake work coming up?

Need to find your home away from home?



0800 673 227
www.quakeaccommodation.govt.nz

MINISTRY OF BUSINESS, INNOVATION & EMPLOYMENT
HĪKINA WHAKATUTUKI New Zealand Government

Free Impartial Advice

For the repair or rebuild of your home

The Residential Advisory Service is a free, independent and easy to use advisory service for residential property owners repairing or rebuilding their homes following the Canterbury earthquakes.

Our experienced, qualified advisors can help you gain a better understanding of your repair and rebuild process, or connect you to other services that may be able to progress your situation.

Get in touch - we're here to help.

RAS
Residential Advisory Service for Property Owners

Call 03 379 7027
or 0800 777 299
Or visit advisory.org.nz





Residential repair and rebuild information

Open until 25 June 2015
Eastgate Shopping Centre

Need information to progress your earthquake repair or rebuild?

Talk face to face with earthquake recovery agencies and support services who can help you with your residential earthquake claim.

The In the Know Hub at Eastgate Shopping Centre is open for residents facing rebuild or repair issues. At the Hub, you can talk face to face with earthquake recovery agencies, be connected with other agencies or support services and establish your next step in the residential rebuild or repair process.

The Hub is open Monday to Wednesday, 9am–6pm, and Thursday 9am–8pm. It is closed Friday to Sunday and on public holidays.

Not all agencies are at the Hub every day. The timetable below shows when you will find each agency at the Hub.

Agency	Day	Time
CanCERN	Monday to Wednesday Thursday	9am-6pm 9am-8pm
EQC - to make an appointment call 0800 326 243	Monday to Thursday	9am-5.30pm
Canterbury Earthquake Temporary Accommodation Service (CETAS)	Monday to Thursday	9am-6pm
Earthquake Support Coordination Service	Monday to Wednesday Thursday	9am-6pm 9am-8pm
Residential Advisory Service (RAS)	Monday to Wednesday Thursday	9am-4pm 9am-8pm
Christchurch City Council for consenting queries for land drainage/flooding queries for general enquiries	Monday Monday to Thursday Monday to Thursday	9am-11am 2pm-5pm 9am-1pm

Seminars on residential repair and rebuild topics will be held at the Hub each Thursday at 1pm–2pm and at 6pm–7pm. Presenters will be experts on their topic and you will have an opportunity to ask questions. Space is limited – to book a seat, call **0800 777 HUB (0800 777 482)**.

For more information visit:
www.intheknow.org.nz

The In the Know Hub is a community-led initiative supported by:
CanCERN, Canterbury Earthquake Recovery Authority, Canterbury Earthquake Temporary Accommodation Service, Christchurch City Council, Earthquake Commission, Earthquake Support Coordination Service, Insurance Council of New Zealand, Ministry of Business, Innovation and Employment, Residential Advisory Service and the Canterbury Community Trust.

Useful contacts



Christchurch City Council
03 941 8999
0800 800 169
info@ccc.govt.nz
www.ccc.govt.nz

CERA
0800 RING CERA
0800 7464 2372
info@cera.govt.nz
cera.govt.nz

EQC
0800 DAMAGE
0800 326 243
eqc.govt.nz

SCIRT
03 941 8999
info@scirt.co.nz
strongerchristchurch.govt.nz

Waimakariri District Council
03 311 8900
waimakariri.govt.nz

Selwyn District Council
03 347 2800
03 318 8338
selwyn.govt.nz

Environment Canterbury
03 353 9007
ecan.govt.nz

Canterbury Support Line
0800 777 846

Earthquake Support Coordination Service
0800 777 846

Residential Advisory Service
03 379 7027
0800 777 299
advisory.org.nz

Canterbury Earthquake Temporary Accommodation Service
0800 673 227
quakeaccommodation.govt.nz

What's on...

FIFA U-20 World Cup New Zealand 2015

1-17 June – Christchurch Stadium (AMI Stadium)

In early June, Christchurch will host games featuring football's future legends in FIFA's second-biggest men's tournament.
Various: Adults from \$19, children from \$8 + service fee



Free

Tradie Expo Afternoon

21 May, 3.30pm-5.30pm – Horncastle Arena

Showcasing 75 building and construction industry-related stands, this event is a must for all tradies in/around Christchurch.
FREE



2degrees Comedy Convoy

22 May, 8pm – Isaac Theatre Royal

Steve Wrigley (7 Days) is back from the US to showcase a stunning line-up of top comedians from across the world.
\$39.50



Christchurch Airport Marathon

31 May, 8.30am – Start Cathedral Square

Inspired by the 1974 Commonwealth Games marathon, the Christchurch Airport Marathon is renowned as one of the fastest courses in the world.
Adults from \$35, children from \$15



Salute

28-30 May – Isaac Theatre Royal

A Royal NZ Ballet collaboration with the NZ Army Band to mark the centenary of World War 1.
Various from \$25-\$89.40 + service fee



Te Puna Toi

2-13 June, 8pm – The Gym, The Arts Centre

Footprints/Tapuwaē is a bicultural opera that juxtaposes motifs from Wagner's Ring Cycle with waiata and haka.
\$20-\$30 online booking essential



Trinity Roots 'Citizen' Tour

6 June, 8.30pm

Ferrymead Speight's Ale House
Earlybird \$20, GA \$30

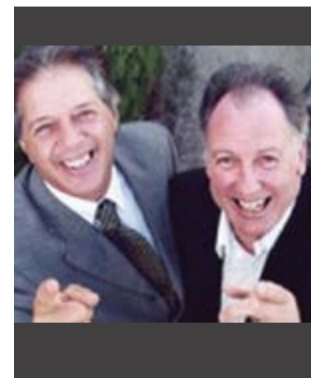

Gary McCormick & Tim Shadbolt

5 June, 6pm

Addington Raceway
Dinner and a show.
\$49



Six60 NZ Tour

29 May, 7pm – Horncastle Arena

After over a year away from NZ stages, the band returns for what will be their biggest and most exciting tour to date.
\$70.50 + service fee



Mainland Tactix v WBOP Magic

Horncastle Arena

31 May, 7.10pm
Support the Tactix.
From \$10



David Cook: Meet Me in the Square

Until 24 May

10am-5pm
209 Tuam Street
FREE



Harness Racing at Addington

Until 24 July

5pm
Addington Raceway
FREE

The events featured on this page are just a selection of what's happening in Christchurch over the next few weeks. Find out more online. ■

Be There >>>
CHRISTCHURCH EVENTS

For more events visit:
bethere.co.nz